

OVERHAUL

HINT:

COMPONENTS: (See page 55-39)

1. DISCHARGE REFRIGERANT FROM REFRIGERATION SYSTEM

SST 07110-58060 (07117-58080, 07117-58090, 07117-78050, 07117-88060, 07117-88070, 07117-88080)

2. REMOVE WIPER LINK ASSY (See page 66-9)

HINT:

Refer to the instructions for removal of the wiper link assy.

3. REMOVE COWL TOP PANEL SUB-ASSY OUTER (See page 26-7)

4. SEPARATE SUCTION HOSE SUB-ASSY

- (a) Install SST to piping clamp.
SST 09870-00015

HINT:

Confirm the direction of the piping clamp claw and SST using the illustration showing on the caution label.

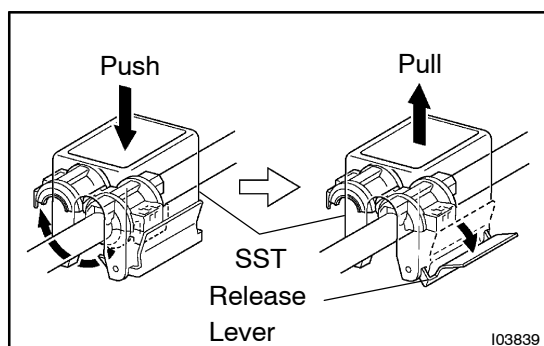

- (b) Push down SST and release the clamp lock.

NOTICE:

Be careful not to deform the tube, when pushing SST.

- (c) Pull SST slightly and push the release lever, then remove the piping clamp with SST.

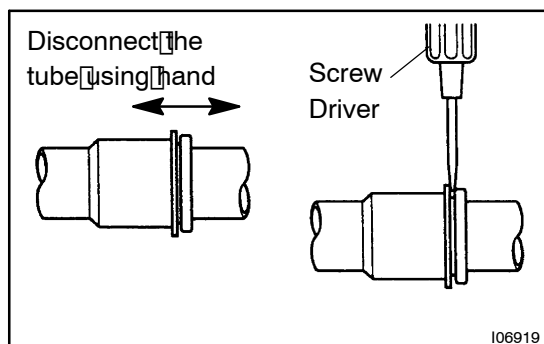

- (d) Disconnect the suction hose sub-assy.

NOTICE:

- **Do not use tools like screwdriver to remove the tube.**
- **Cap the open fittings immediately to keep moisture or dirt out of the system.**

5. SEPARATE COOLER REFRIGERANT LIQUID PIPE B

SST 09870-00025

HINT:

Disconnect cooler refrigerant liquid pipe B in the same way as the suction hose sub-assy.

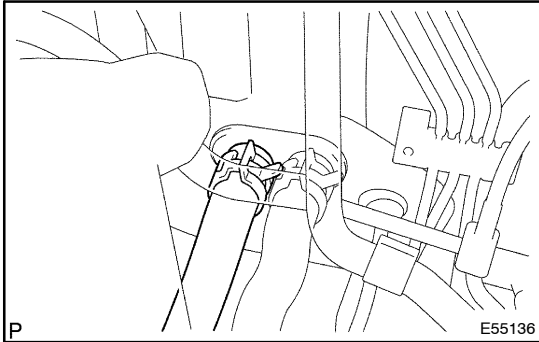

6. SEPARATE HEATER WATER OUTLET HOSE A(FROM HEATER UNIT)

- (a) Slide the clip and disconnect the heater water outlet hose A.

7. SEPARATE HEATER WATER OUTLET HOSE A(FROM HEATER UNIT)(W/ REAR HEATER)

HINT:

Disconnect in the same way as the heater water outlet hose A.

8. SEPARATE HEATER WATER INLET HOSE A

- (a) Slide the clip and disconnect the heater water inlet hose A.

9. SEPARATE HEATER WATER INLET HOSE A(W/ REAR HEATER)

HINT:

Disconnect in the same way as the heater water inlet hose A.

10. REMOVE INSTRUMENT PANEL LOWER

HINT:

Refer to the instructions for removal of the instrument panel lower.

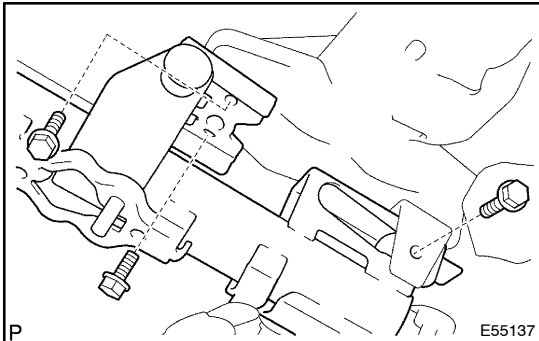

11. SEPARATE STEERING COLUMN ASSY

- (a) Remove the 3 bolts, disconnect the steering column assy from the instrument panel reinforcement.

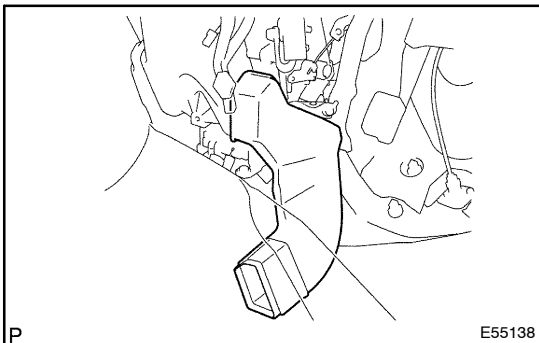

12. REMOVE AIR DUCT REAR NO.1

- (a) Remove the floor carpet.

HINT:

Turn up the floor carpet to a certain extent so that the air duct rear No. 1 can be remove.

- (b) Remove the air duct rear No. 1.

HINT:

Remove it in the same way with the air duct rear No. 1.

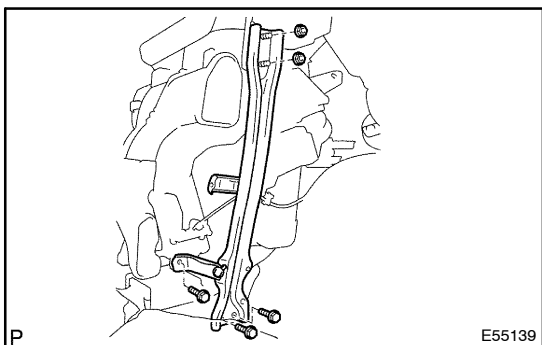

13. REMOVE INSTRUMENT PANEL BRACE SUB-ASSY NO.1

- (a) Disconnect the connector clamp.
- (b) Remove the 3 bolts, 2 nuts and instrument panel brace sub-assy No. 1.

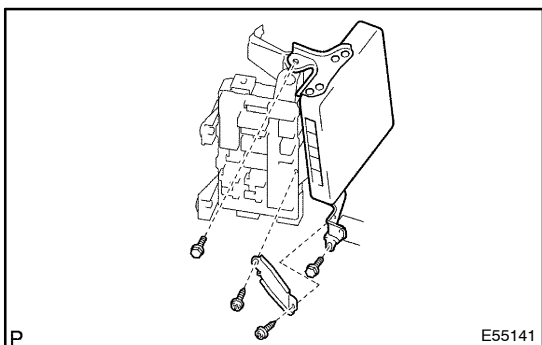

14. SEPARATE ECM

- (a) Remove the 2 screws and engine control computer bracket No. 4.
- (b) Remove the 2 bolts and ECM with connectors still connected.

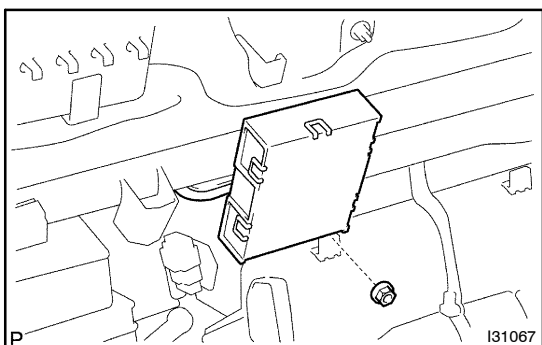

15. SEPARATE AIR CONDITIONING AMPLIFIER ASSY

- (a) Remove the nut and air conditioning amplifier assy with connectors still connected.

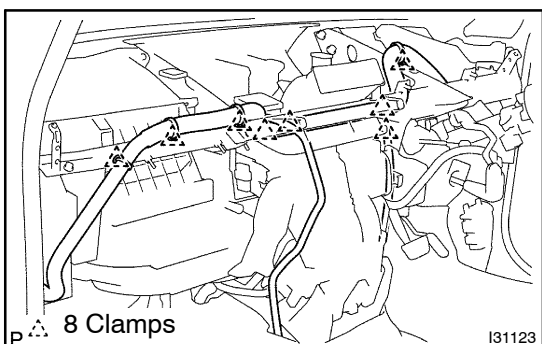

16. REMOVE INSTRUMENT PANEL REINFORCEMENT

- (a) Release the 8 clamps, disconnect the wire harness from the instrument reinforcement.

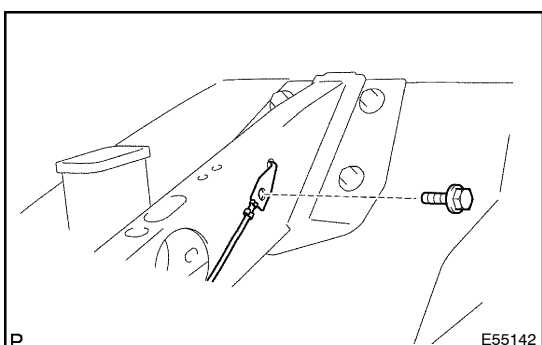

- (b) Remove the bolt, disconnect the earth wire from the instrument reinforcement.

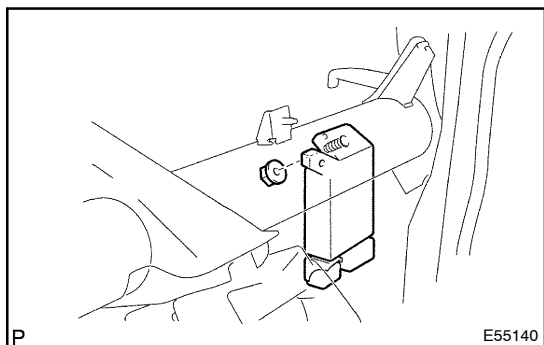

- (c) Remove the nut, disconnect the instrument panel junction block sub-assy.
- (d) Remove the 12 bolts, heater to register duct No. 1 and instrument reinforcement assy.

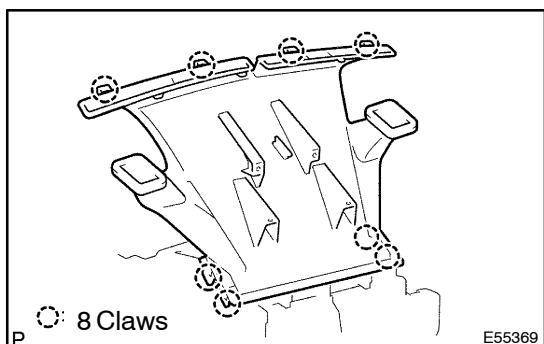
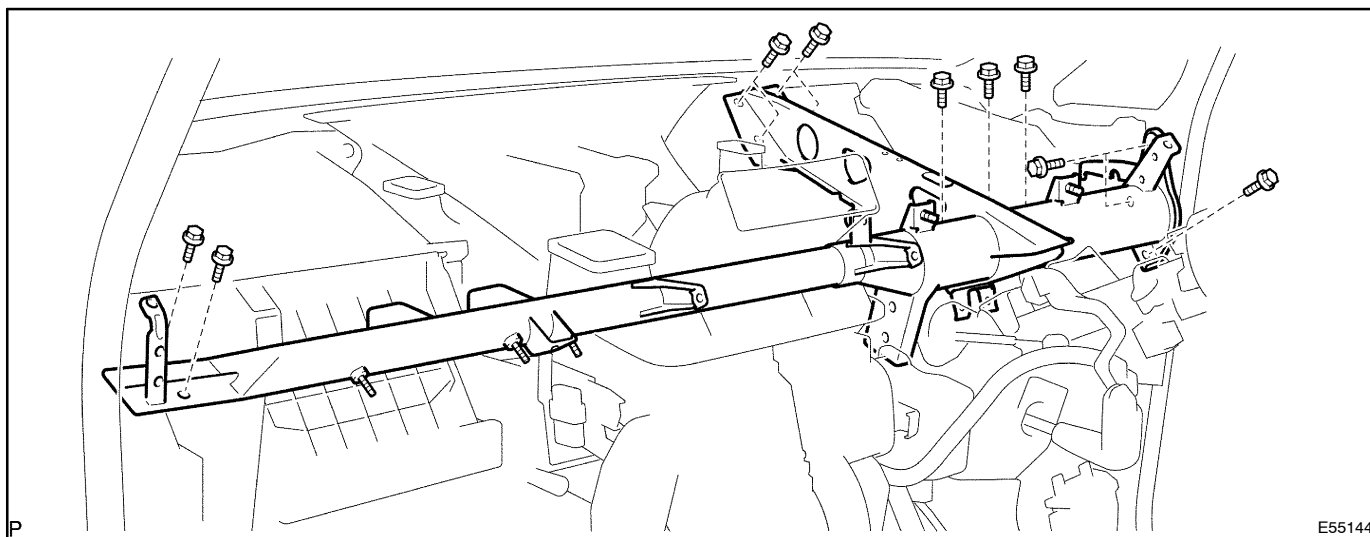

17. REMOVE DEFROSTER NOZZLE ASSY

- (a) Release the 8 fitting claws , remove the defroster nozzle assy.

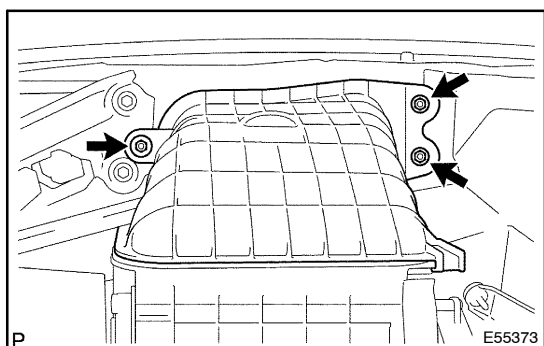

18. REMOVE AIR DUCT SUB-ASSY

- (a) Remove the 3 nuts and air duct sub-assy.

**19. REMOVE AIR DUCT NO.1**

- (a) Release the 3 fitting claw , remove the air duct No. 1.

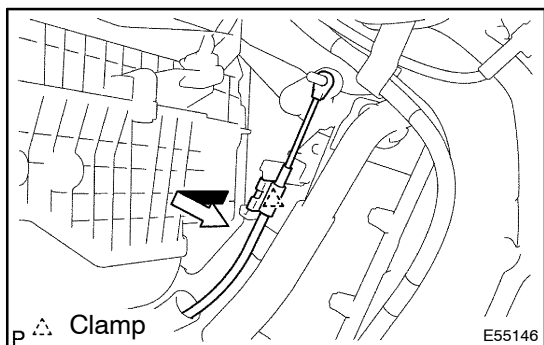
**20. SEPARATE CONTROL CABLE(W/ REAR HEATER)**

- (a) Disconnect the outer cable from the clamp.
 (b) Disconnect the inner cable and control cable.

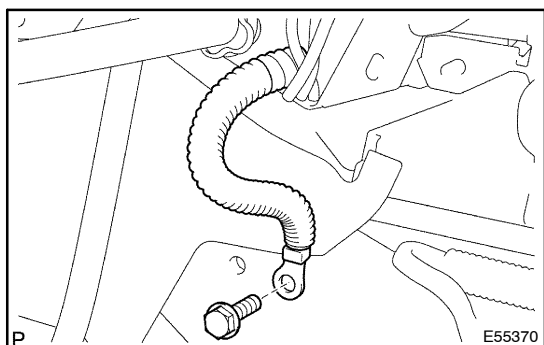
**21. REMOVE AIR CONDITIONER UNIT ASSY**

- (a) Disconnect the connectors connecting the cowl wire No. 2 and vehicle harness.
 (b) w/ LHD PTC Heater model:
 Separate the earth bolt for PTC heater.

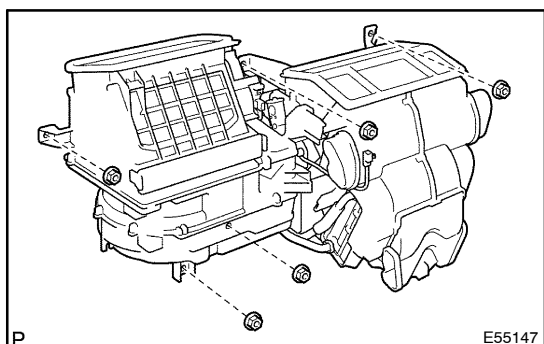

- (c) Remove the 5 nuts and air conditioner unit assy.

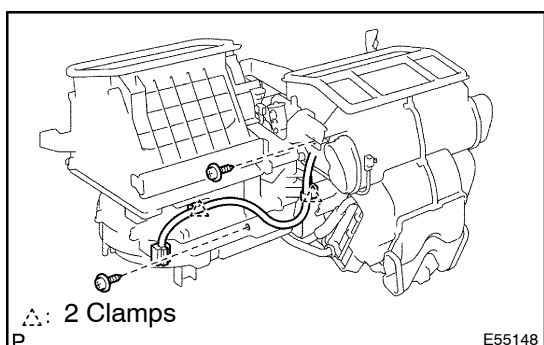
**22. REMOVE AIR CONDITIONING RADIATOR ASSY**

- (a) Remove the 2 screws and 2 clamps.
 (b) Disconnect the connection between the blower assy and the air conditioner radiator assy and remove the latter assy.

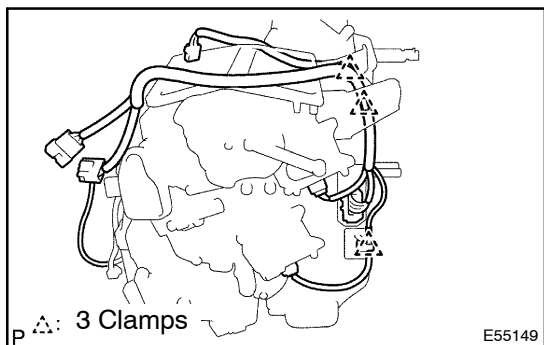
**23. REMOVE COWL WIRE NO.2**

- (a) Release the connector and 3 clamps, remove the cowl wire No. 2.

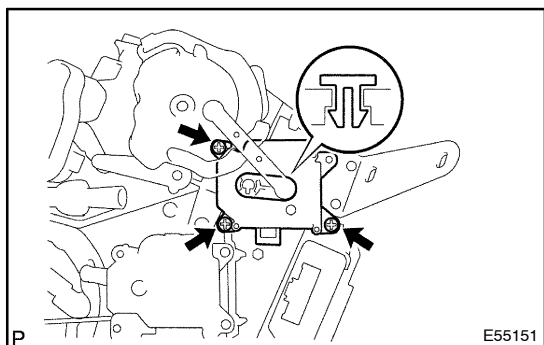
**24. REMOVE MODE DAMPER SERVO SUB-ASSY**

- (a) Remove the 3 screws, rod and mode damper servo sub-assy.

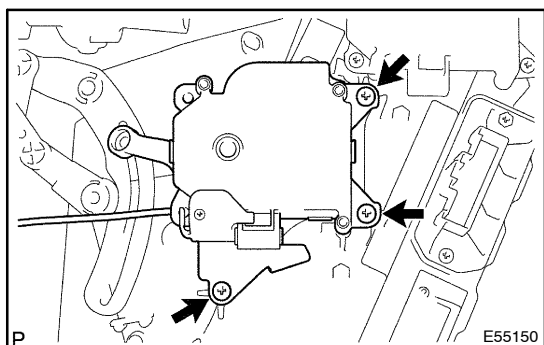
**25. REMOVE AIRMIX DAMPER SERVO SUB-ASSY**

- (a) Remove the 3 screws, rod and air mix damper servo sub-assy.

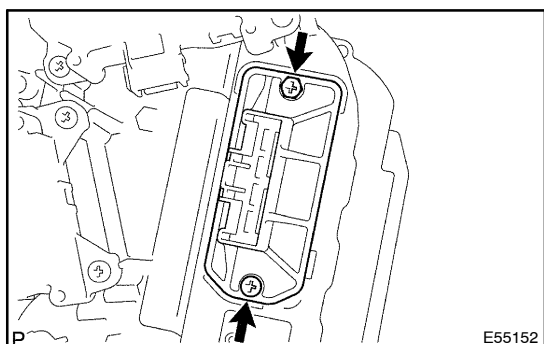
**26. REMOVE BLOWER RESISTOR(2 WAY FLOW HEATER)**

- (a) Remove the 2 screws and blower resistor.

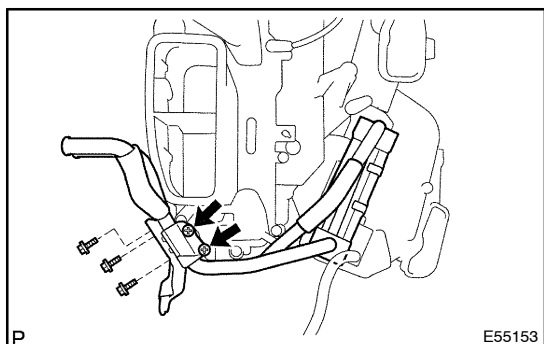
**27. REMOVE HEATER RADIATOR UNIT SUB-ASSY**

- (a) Remove the 5 screws and 2 brackets.
(b) Remove the heater radiator unit sub-assy from the air conditioner radiator assy.

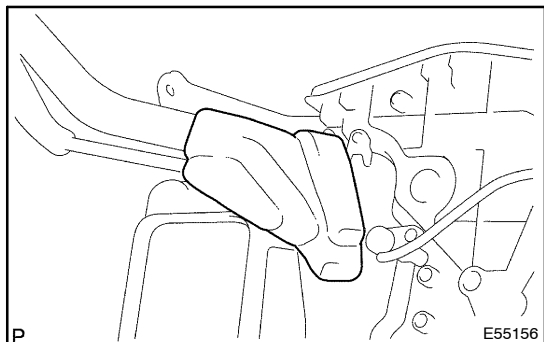
28. REMOVE COOLER THERMISTOR NO.1**29. REMOVE AIR CONDITIONING TUBE ASSY**

- (a) Remove the packing.

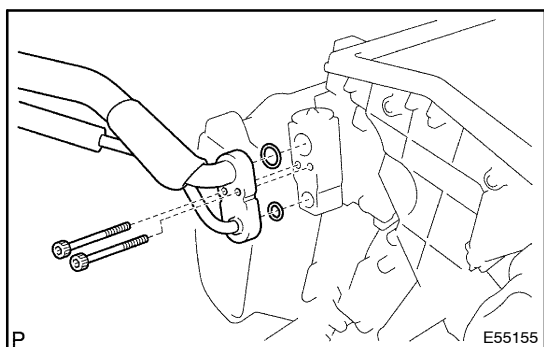

- (b) Using a hexagon wrench 4 mm (0.16 in.), remove the 2 hexagon bolts and air conditioning tube assy.
- (c) Remove the 2 O-rings from the air conditioning tube assy.

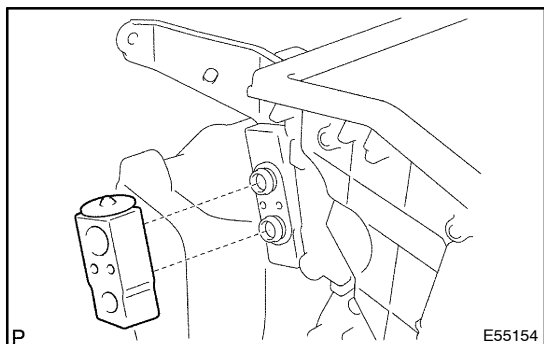
**30. REMOVE COOLER EXPANSION VALVE**

- (a) Remove the cooler expansion valve from the cooler evaporator sub-assy No. 1.

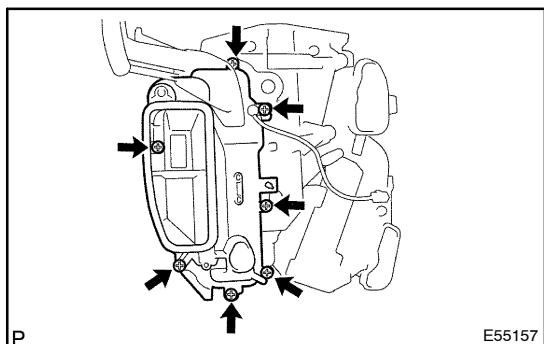
**31. REMOVE COOLER EVAPORATOR SUB-ASSY NO.1**

- (a) Remove the 7 screws and cover.

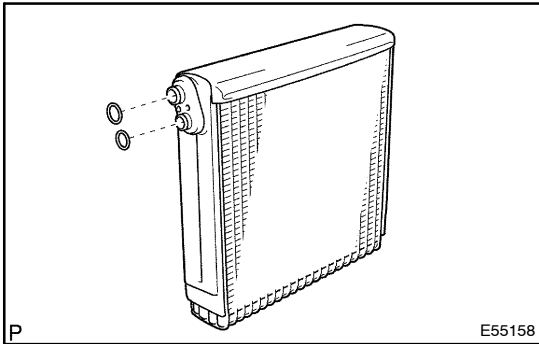

- (b) Remove the cooler evaporator sub-assy No. 1 from the air conditioner radiator assy.
- (c) Remove the 2 O-rings from the cooler evaporator sub-assy No. 1.

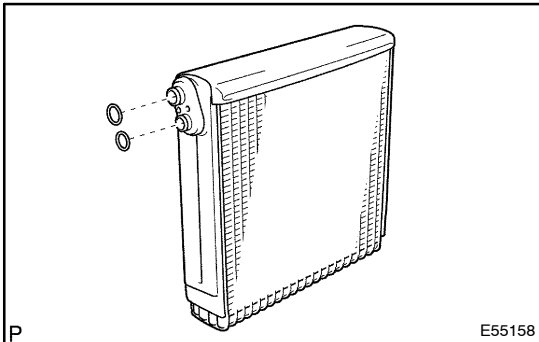

32. INSTALL COOLER EVAPORATOR SUB-ASSY NO.1

- (a) Apply compressor oil to the contact surfaces of 2 new O-rings and the cooler cooler expansion valve and install them.
Compressor oil: ND-OIL 8 or equivalent
- (b) Install the cooler evaporator sub-assy No. 1 to the air conditioner radiator assy.

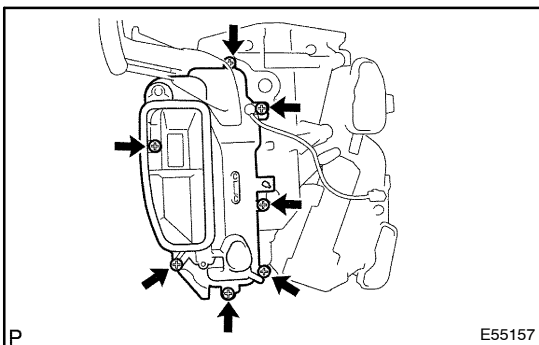

- (c) Install the cover with the 7 screws.

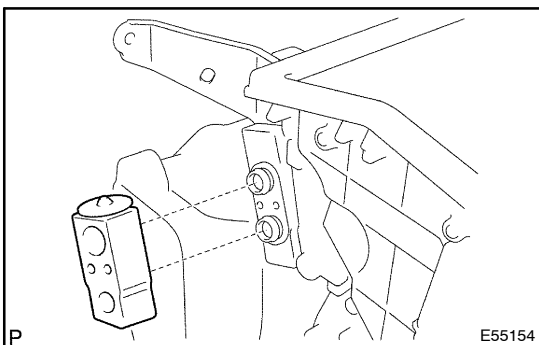

33. INSTALL COOLER EXPANSION VALVE

- (a) Install the cooler expansion valve to the cooler evaporator No. 1.

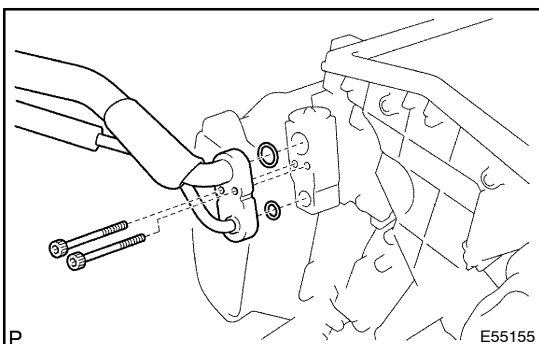

34. INSTALL AIR CONDITIONING TUBE ASSY

- (a) Apply compressor oil to the contact surfaces of 2 new O-rings and the air conditioner tube assy and install them.
Compressor oil: ND-OIL 8 or equivalent
- (b) Using a hexagon wrench 4 mm (0.16 in.), install the air conditioner tube assy and 2 hexagon bolts to the cooler evaporator sub-assy No. 1.

Torque: 3.5 N·m (35 kgf·cm, 30 in.·lbf)

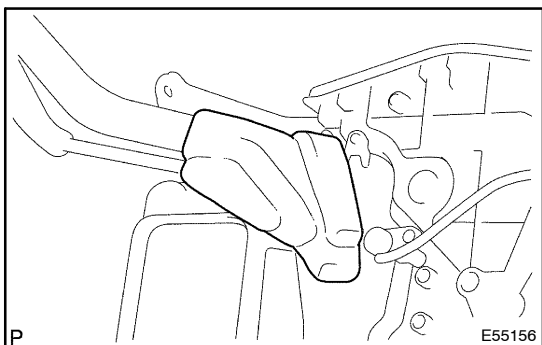

(c) Install the packing.

HINT:

Securely attach so that the gap in the packing will not be made.

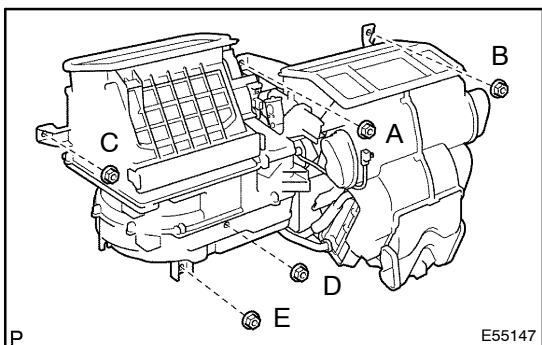

35. INSTALL AIR CONDITIONER UNIT ASSY

(a) Install the air conditioner unit assy with the 5 nuts.

HINT:

Tighten in the order of A, B, C, D and E.

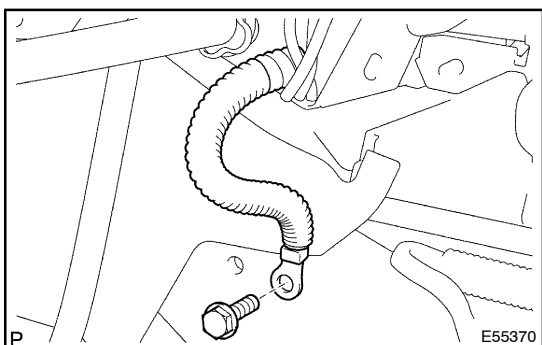

(b) Connect the connectors connecting the cowl wire No. 2 and vehicle harness.

(c) w/ LHD PTC Heater model:

Install the earth bolt for PTC heater.

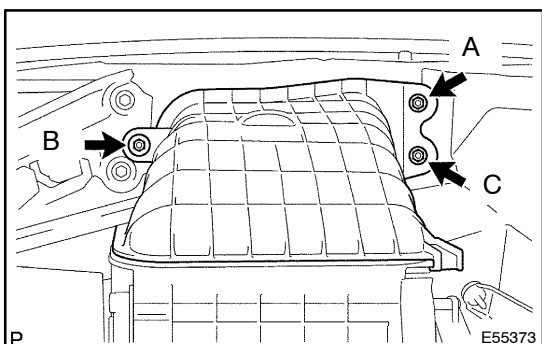

36. INSTALL AIR DUCT SUB-ASSY

(a) Install the air duct sub-assy with the 3 nuts.

HINT:

Tighten in the order of A, B, C.

37. INSTALL INSTRUMENT PANEL REINFORCEMENT

- (a) Install the instrument panel reinforcement and heater to register duct No. 1 with the 12 bolts.

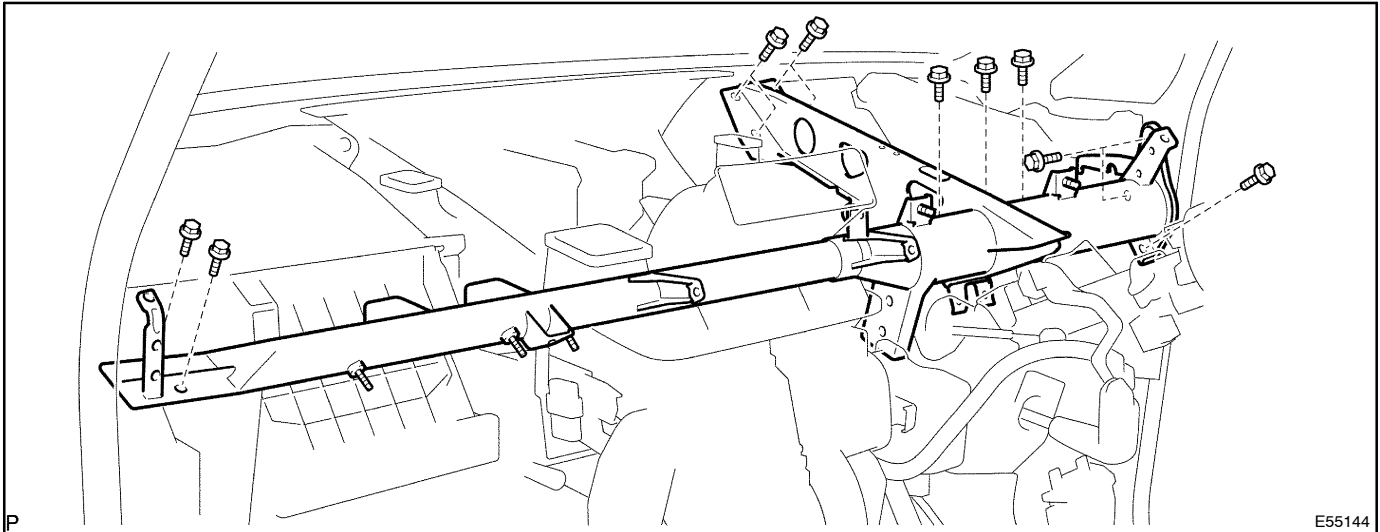

- (b) Install the instrument panel junction block sub-assy with the nut.

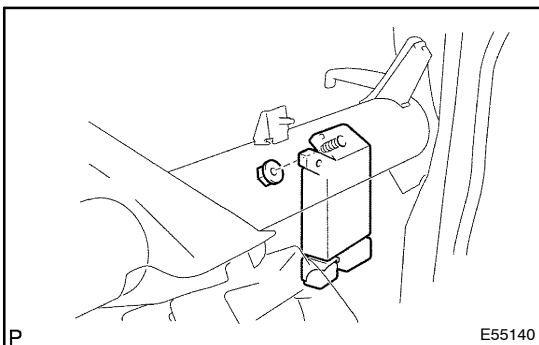

- (c) Install the wire harness with the bolt.
Torque: 8.4 N·m (85 kgf·cm, 73 in·lbf)

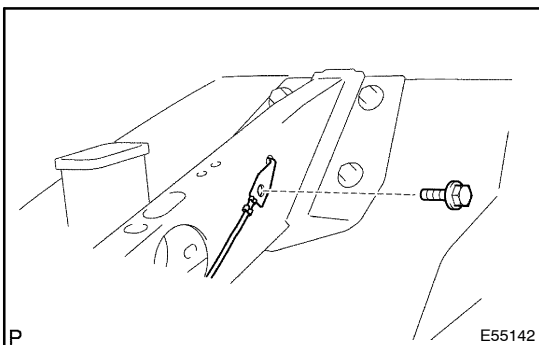

- (d) Install the wire harness with the 8 clamps.

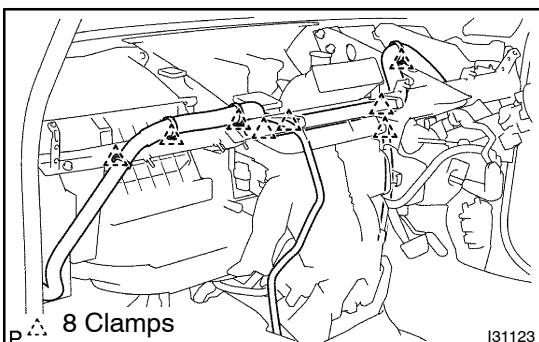

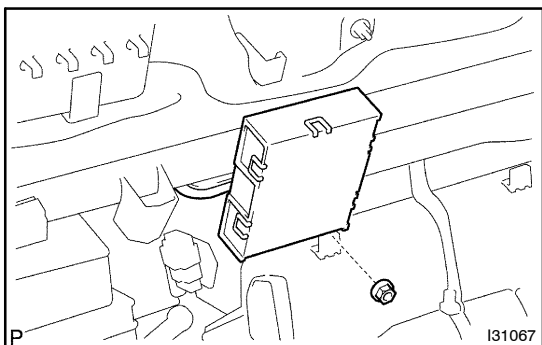

38. INSTALL AIR CONDITIONING AMPLIFIER ASSY

- (a) Install the air conditioning amplifier assy with the nut.

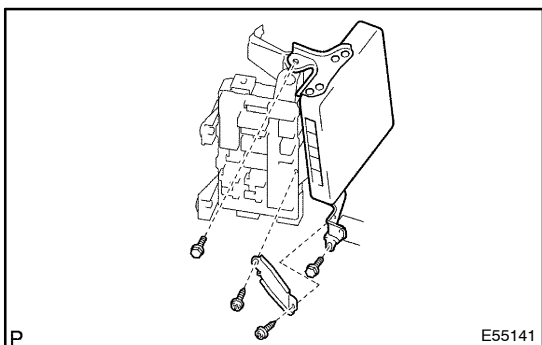

39. INSTALL ECM

- (a) Install the ECM with the 2 bolts.
Torque: 5.5 N·m (55 kgf·cm, 49 in. lbf)
 (b) Install the engine control computer bracket No. 4 with the 2 screws.

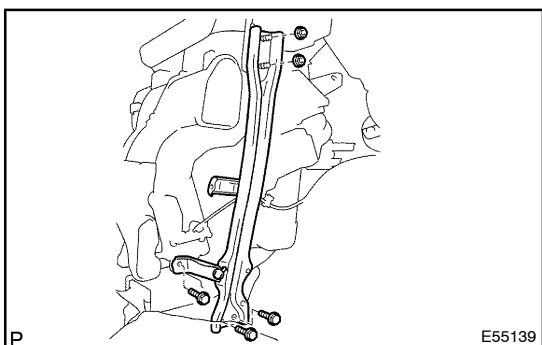

40. INSTALL INSTRUMENT PANEL BRACE SUB-ASSY NO.1

- (a) Install the instrument panel brace sub-assy No. 1 with the 3 bolts and 2 nuts.
 (b) Install the connector clamp.

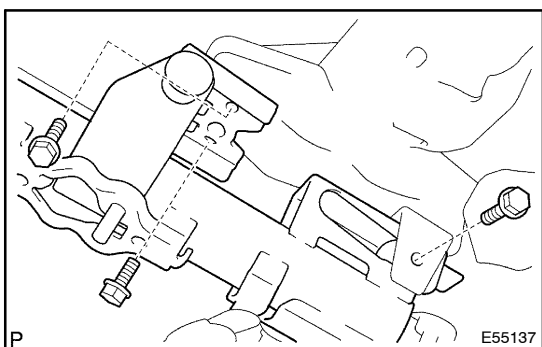

41. INSTALL STEERING COLUMN ASSY

- (a) Install the steering column assy with the 3 bolts.
Torque: 21 N·m (214 kgf·cm, 15 ft·lbf)

42. INSTALL INSTRUMENT PANEL SUB-ASSY

(See page 71-10)

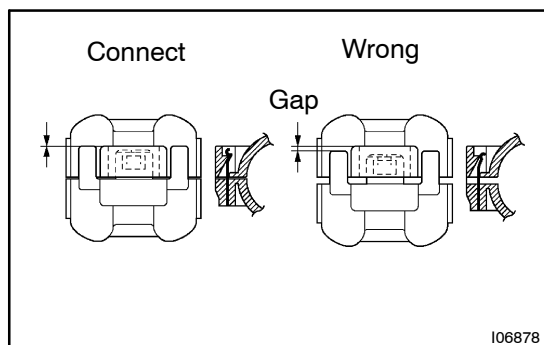
**43. INSTALL SUCTION HOSE SUB-ASSY**

- (a) Lubricate new O-ring with compressor oil and install them to the hose.

Compressor oil: ND-OIL or equivalent

- (b) Install the suction hose sub-assy and piping clamp.

HINT:

After connection, check the fitting for claw of the piping clamp.

44. INSTALL COOLER REFRIGERANT LIQUID PIPE

HINT:

Install in the same way as the suction hose sub-assy.

45. INSTALL COWL TOP PANEL SUB-ASSY OUTER

(See page 26-7)

46. INSTALL FR WIPER ARM LH (3 LINK TYPE FR WIPER)**47. INSTALL FR WIPER ARM LH (4 LINK TYPE FR WIPER)****48. ADD COOLANT 1AZ-FE (See page 16-6)**

1CD-FTV (See page 16-19)

49. CHARGE REFRIGERANT (See page 55-28)

SST 07110-58060 (07117-58060, 07117-58070, 07117-58080, 07117-58090, 07117-78050, 07117-88060, 07117-88070, 07117-88080)

Specified amount:

Single A/C: 500 ± 30 g (17.63 ± 1.05 oz.)

Dual A/C: 800 ± 30 g (28.21 ± 1.05 oz.)

50. WARM UP ENGINE**51. INSPECT LEAKAGE OF REFRIGERANT (See page 55-28)**